

DO NOT SCALE
IF IN DOUBT ASK

- NOTES:
 N1 RELEASE TRAVEL: TO BE LIMITED BY AN EXTERNAL STOP.
 N2 DIRECTION OF RELEASE TRAVEL.
 N3 TIGHTENING TORQUE OF CLUTCH MOUNTING BOLTS = 22Nm
 N4 TOTAL WEAR OF BOTH DRIVEN PLATES MUST NOT EXCEED THE WEAR IN FIGURE ON THE TABLE BELOW.
 N5 ALIGN DRIVEN PLATES USING DOT MARKED HUBS AS A GUIDE.
 N6 CUSTOMER PART NUMBER.

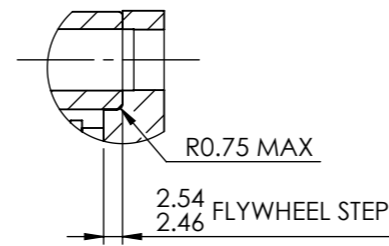

DETAIL X
SCALE 1 : 1

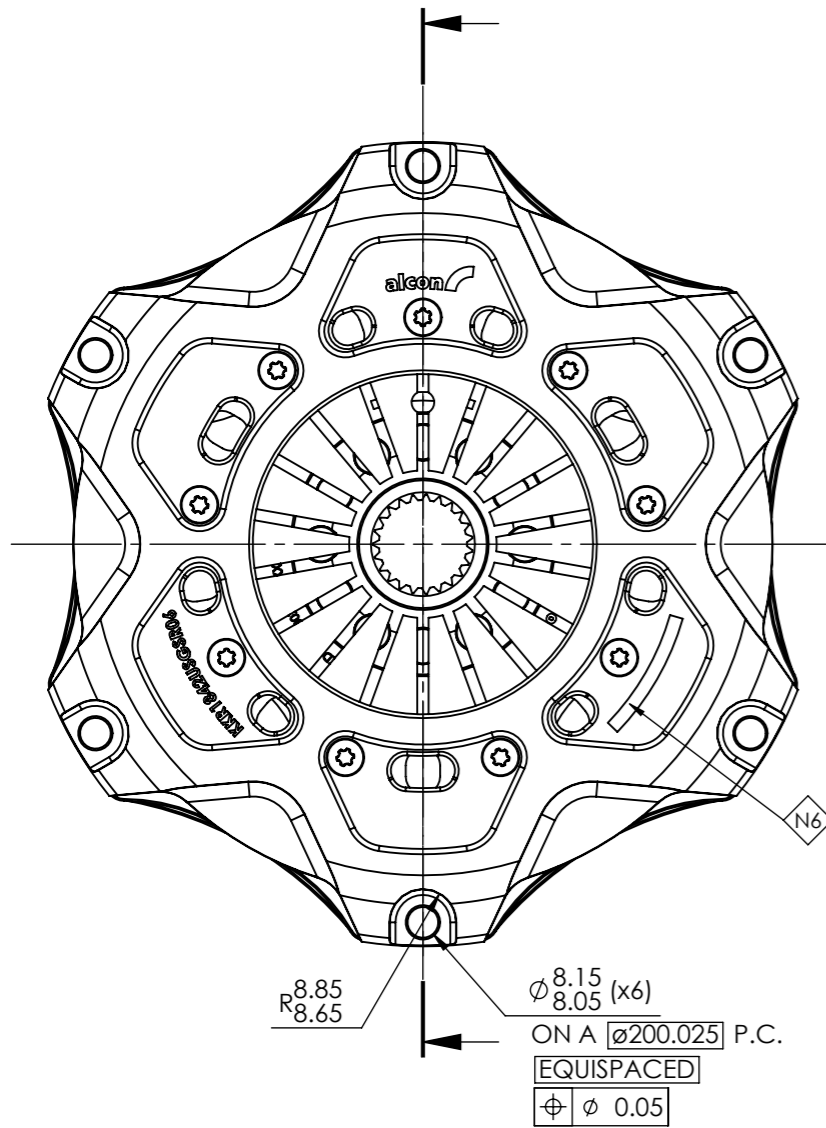
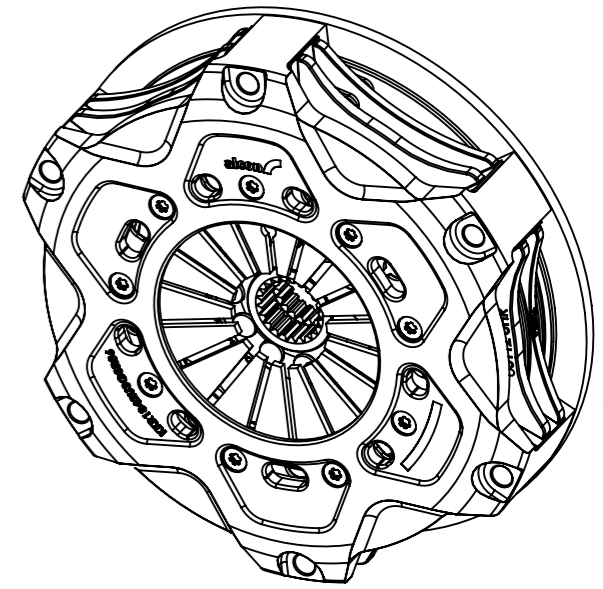

STEP FLYWHEEL (SR)

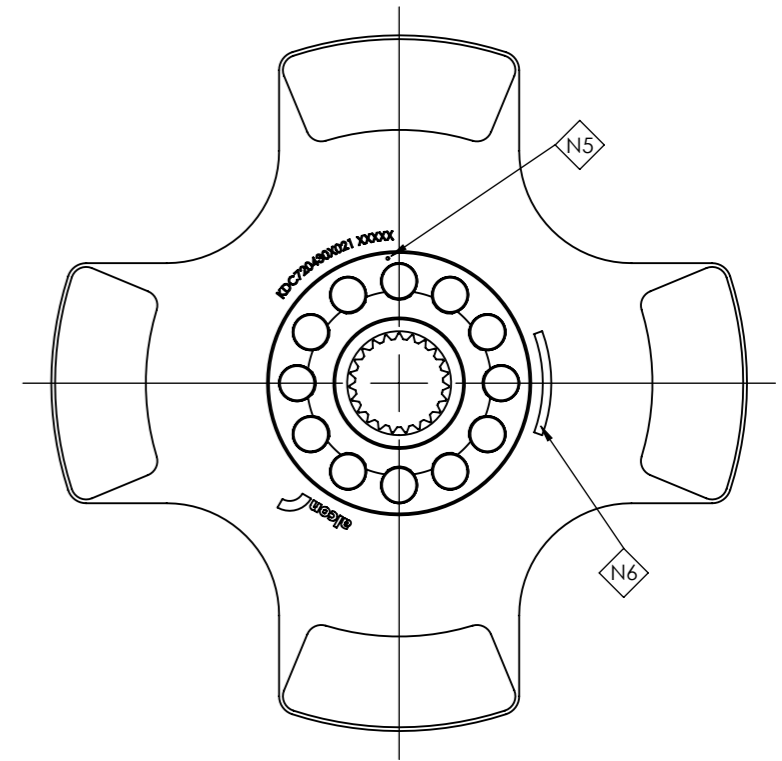

DRIVEN PLATES
 KDC720430X021 - 1 OFF (COVER SIDE)
 KDC720430X022 - 1 OFF (FLYWHEEL SIDE)
 (ORDERED SEPARATELY)

CUSTOMER PART NUMBER

5FR 141 041

CLUTCH ASSEMBLY PART NUMBER	SPRING IDENTITY	RELEASE RATIO	RELEASE LOAD (@ TRAVEL)		RECOMMENDED MAX DYNAMIC TORQUE CAPACITY	EST. ASSEMBLY MASS (inc. 4 PAD DRIVEN PLATES)	EST. ASSEMBLY INERTIA (inc. 4 PAD DRIVEN PLATES)	EST. DRIVEN PLATES ONLY INERTIA	WEAR IN	SET UP HEIGHT NEW	SET UP HEIGHT MAX WORN
			Ø44mm BEARING	Ø52mm BEARING							
KKR1842USGSR06	SINGLE GREY	ULTRA	2.6kN	2.8kN	730Nm (537 lb.ft)	3.55Kg	0.01966 Kgm ²	0.00364 Kgm ²	0.75mm	37.35/38.28	41.59

B KDC720430X021 & X022 WAS KDC720430X020 2 OFF. KKR1842USGSR06 WAS KKR1842USGSR05. DRAWING VIEWS UPDATED TO SUIT. NOTES N5 AND N6 ADDED (EC3078)		ADS 11.11.19 AS 11.11.19
A FOR DISCUSSION.		ADS 27.02.19
Issue	Change	LOC DRN BY / Date CHK BY / DATE APP BY / Date
DRAWN IN SOLIDWORKS WEIGHT: --- grams FINISH: --- ALL DIMENSIONS ARE BEFORE TREATMENT UNLESS STATED TOLERANCES UNLESS STATED: 25.2 ANGLES: 25.0°	SCALE: 1:2 MATERIAL: --- PART NAME: (Max. 80 chars) PART NUMBER: KKR1842USGSR06 SEAT TCR	ALCON COMPONENTS LIMITED APOLLO TAMWORTH STAFFORDSHIRE B79 7TN TEL: +44(0)1827 723700 THIS DRAWING AND INFORMATION THERE UPON IS THE PROPERTY OF ALCON COMPONENTS LTD. IT IS LENT ON THE CONDITION THAT IT IS WHOLELY UNDISCLOSED TO ANY PERSON WITHOUT WRITTEN CONSENT OF ALCON AND SHALL BE RETURNED TO ALCON COMPONENTS LTD. DATE: --- CHECKED: --- APPROVED: --- ALCON engineering your advantage
Ø184 (7.25") CERAMETALLIC TWIN PLATE CLUTCH INSTALLATION		B 1 of 1 A3